

Douglas County, Nebraska Property Record - R0109250001

Information is valid as of 2018-04-13

[Print Report](#)
[Treasurer's Tax Report](#)
Great Feature → → → [Subdivision Sales Search](#)

Owner

ROGERT DON

26515 BLONDO ST
 WATERLOO NE 68069-0000

Property Information

Key Number:	0925 0001 01
Account Type:	Commercial
Parcel Number:	0109250001
Parcel Address:	26405 BLONDO ST DOUGLAS COUNTY NE 68069-0000
Legal Description:	LANDS SEC-TWN-RGE 18-15-10 S 120 N 153 W 120 E 153 FT NE 1/4 NE 1/4 120 X 120

Value Information

	<i>Land</i>	<i>Improvement</i>	<i>Total</i>
2018	\$11,900.00	\$109,000.00	\$120,900.00
2017	\$11,900.00	\$109,000.00	\$120,900.00
2016	\$11,900.00	\$109,000.00	\$120,900.00
2015	\$11,900.00	\$109,000.00	\$120,900.00
2014	\$8,200.00	\$79,500.00	\$87,700.00
2013	\$8,200.00	\$79,500.00	\$87,700.00

[Show All Transactions](#)

Land Information

<i>Acres</i>	<i>SF</i>	<i>Units</i>	<i>Depth</i>	<i>Width</i>	<i>Vacant</i>
0.33	14400.0	0.0	0.0	0.0	null

Land Attributes

<i>Attribute</i>	<i>Attribute Description</i>
Negative Influence	Flood Plain 2
Negative Influence	Location 50

Improvement Information

Building 1

--	--



JUNE 2014 DOUGLAS COUNTY ASSESSOR

[CLICK TO ENLARGE IMAGE](#)

26405 Blondo Street
Office Building

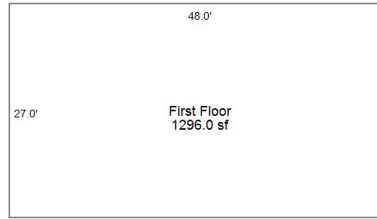

Sketch by Apex Medina™

[CLICK TO ENLARGE IMAGE](#)

Square Footage:	1296.0	Percent Complete:	100.0%
Perimeter	150.0	Quality:	Fair
Unit Type:		Condition:	Average
Built As:	Office Building	Condo Square Footage:	0.0
HVAC:	Complete HVAC	Rooms:	0.0
Exterior:		Units:	1.0
Interior:		Baths:	0.0
Roof Cover:		Bedrooms:	0.0
Roof Type:	Flat	Stories:	1.0
Floorcover:		Foundation:	
		Sprinkler Square Footage:	0.0

<i>Year Built</i>	<i>Year Remodeled</i>	<i>Percent Remodeled</i>	<i>Adjusted Year Built</i>	<i>Physical Age</i>
1972	1998	0%	1972	0

<i>Detail Type</i>	<i>Detail Description</i>	<i>Units</i>
Add On	Ob Paving Asphalt Park	6500.0

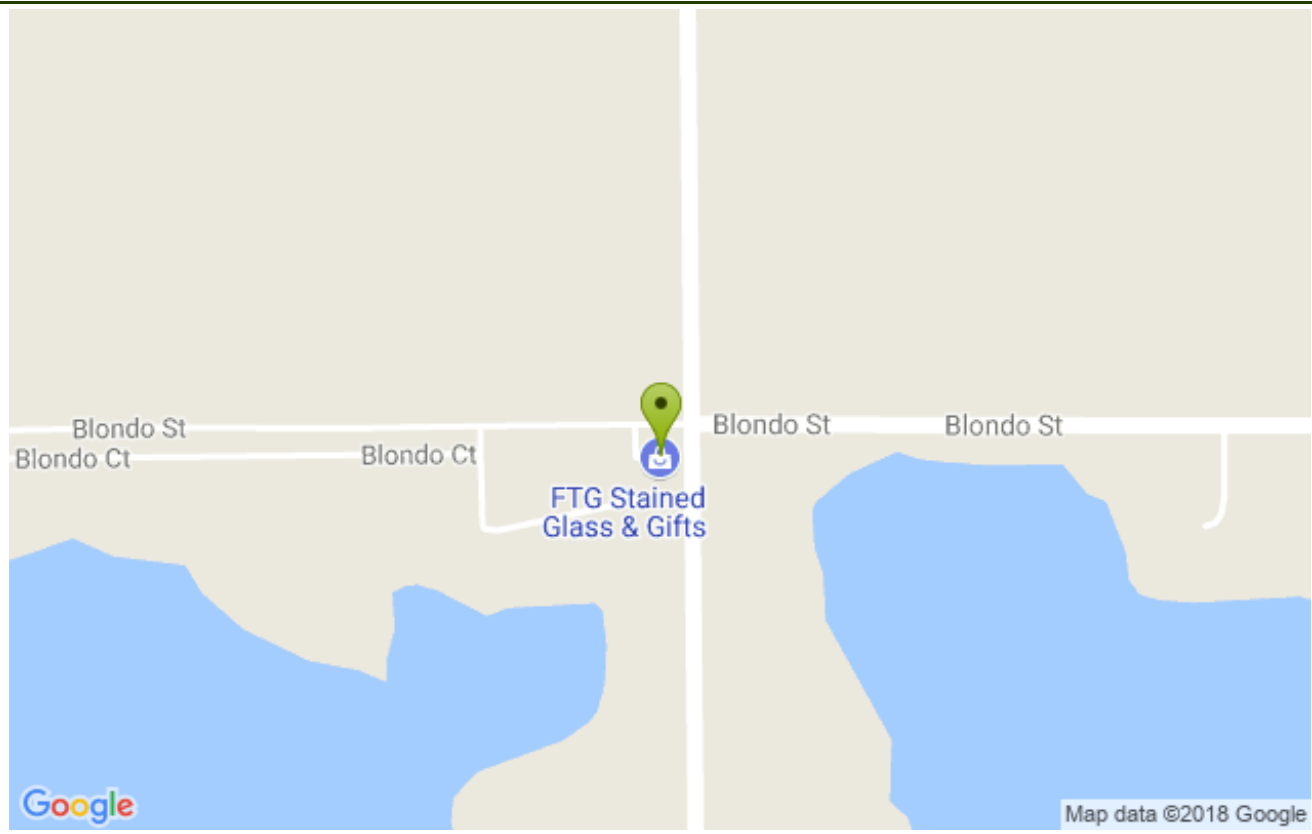

To interact more fully with Google Maps and Street View go to this link [Google](#).